

Data sheet for Load Cells

S-Beam Load Cells

Series KM500

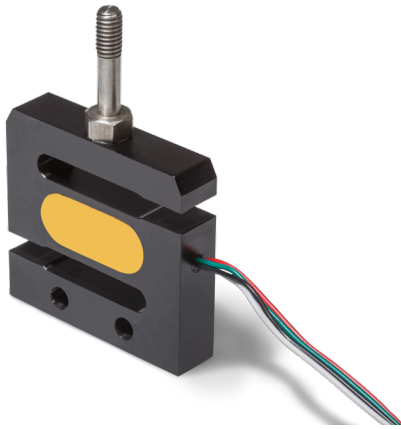

- Very compact S-Beam for confined space
- Force transmission M6 outer thread
- Strain gauge
- Aluminium alloy
- Protection IP54
- Calibration including measurement data

The load cells of the KM500 series with M6 outer thread are specially designed for integration and installation in complex applications. The force sensor is available with a measuring range of 500 N.

Data Load Cell

Rated force	500N
Rated characteristic value	2,0 mV / V of rated output
Relative error of characteristic value	≤ 5 % of rated output
Relative repeatability error	≤ 0,03 % of rated output
Relative reversibility error	≤ 0,03 % of rated output
Relative linearity error	≤ 0,03 % of rated output
Relative deviation of zero signal	≤ 3 % of rated output
Rated displacement	≤ 0,7 mm
Input resistance	410 ±5Ω
Output resistance	350 ±5Ω
Insulation resistance	≥ 5 GΩ @ 50 VDC
Maximum operating force	≤ 150 % of rated force
Rated range of excitation voltage	≤ 10 V DC/AC
Operating range of excitation voltage	≤ 15 V DC/AC
Rated temperature range	-10 °C..+40 °C
Operating temperature range	-10 °C..+70 °C
Protection	IP54
Temperature effect on characteristic value	≤ 0,02 % of output / 10 K
Temperature effect on zero signal	≤ 0,02 % of rated output / 10 K
Creep under load	≤ 0,03 % of rated output
Cable dimension	4 x AWG28
Cable length from body	ca. 12 cm
Body material	Aluminium alloy

Terms according to guideline VDI / VDE / DKD 2638

Data sheet for Load Cells

S-Beam Load Cells

Series KM500

Order code

Description	Selection: standard=black/bold, possible options=grey/cursive		
Series:	KM500		
Connecting cable: Cable length 12 cm		K	
Rated force: 500 N			500N

Accessories (not included in delivery)

Measuring amplifier	IMA2 DMS
----------------------------	----------

Drawing

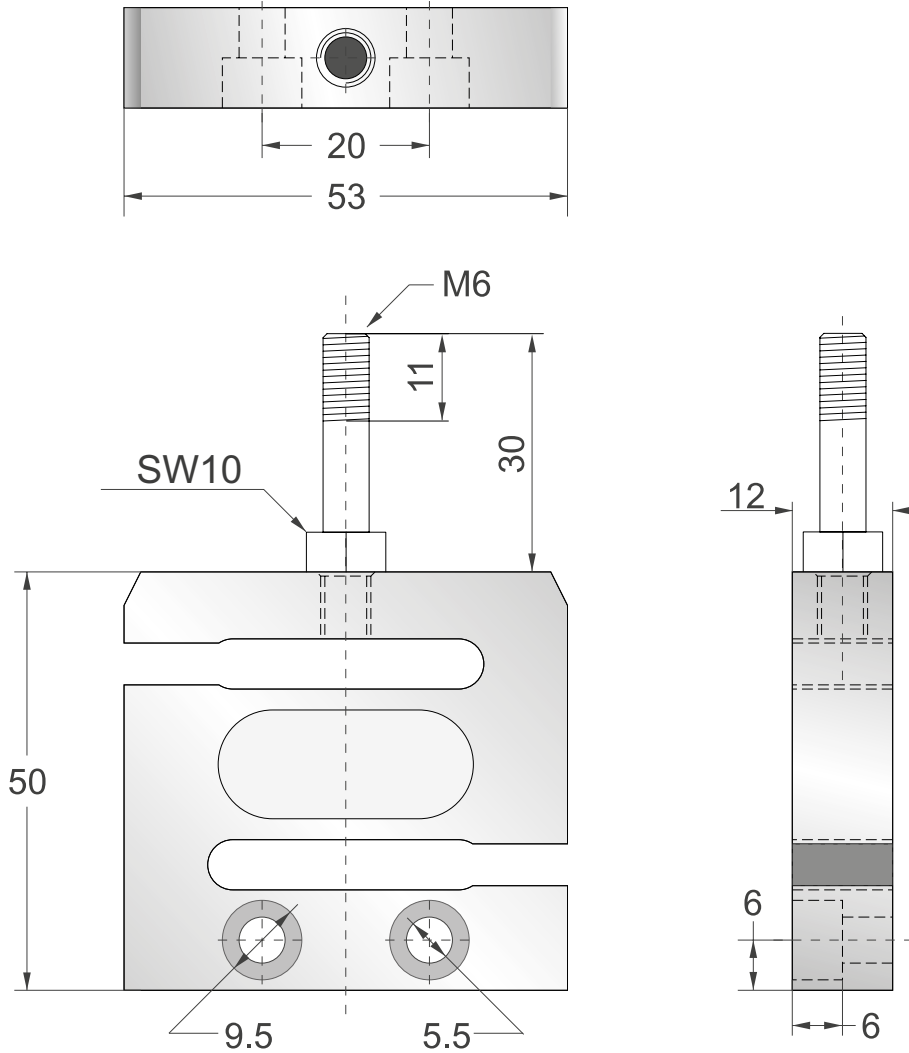

Dimensions in mm

Cable assignment

For tension:

Red: +input
 Black: -input
 White: -output
 Green: +output

For pressure:

Red: +input
 Black: -input
 White: +output
 Green: -output

Connection diagram tension

